

FILTER OVERVIEW WITH SERVICE INTERVALS AND CAPACITIES

6R Final Tier 4 (FT4) Series Row-Crop Tractors – 6145R, 6155R, 6155RH, 6175R, 6195R and 6215R

ENGINE

OIL FILTER [RE539279](#)

Replace after first 100 hours and every 750 hours thereafter or annually.

The extended 750 hour interval is only allowed if using Plus-50™ II oil, JD OEM Oil Filter and diesel fuel with sulfur content less than 15mg/kg (15 ppm).

Change Oil and Filter after every 500 hours, if conditions are not met.

(Click here for [capacity](#))

ENGINE

CRANKCASE VENT FILTER

[DZ105100](#) (W/ DIESEL OXIDATION CATALYST / DIESEL PARTICULATE FILTER)
[DZ105796](#) (W/ DIESEL OXIDATION CATALYST)

Replace after every 1500 hours or 2 years, whichever occurs first.

ENGINE

PRIMARY FUEL FILTER

[DZ115391](#) (6145R, 6155R)
[DZ115391](#) (6175R, 6195R, 6215R (S/N 027001-))

SECONDARY FUEL FILTER

[DZ115392](#) (6145R, 6155R)
[DZ115392](#) (6175R, 6195R, 6215R (S/N 027001-))

FUEL FILTER KIT (PRIMARY & SECONDARY)

[RE556406](#) (6175R, 6195R, 6215R (S/N -027000))

Replace after every 750 hours.

FRONT PTO

OIL FILTER [DE30500](#)

Replace after every 500 hours.

HYDRAULICS

OIL FILTER

[AL169573](#) – W/ 45 cm³ PUMP
[AL203341](#) – W/ 60 cm³ PUMP

Replace after first 100 hours then after first 750 hours and every 750 hours thereafter. Change Transmission Oil Filter as well.

(Click here for [capacity](#))

CAB

RECIRCULATION AIR FILTER (QTY 2) W/ AC [L214634](#)
 RECIRCULATION AIR FILTER (QTY 2) W/O AC [L205372](#)

Replace after every 1500 hours, or 2 years, or as required, or with Engine Primary Air Filter, whichever occurs first.

(Activated Carbon Kit) [AL208648](#)

Never clean. Replace after every 750 hours or 1 year or with Engine Primary Air Filter, whichever occurs first.

CAB

FRESH AIR FILTER [AL220527](#)

Replace after every 1500 hours, or 2 years, or as required, or with Engine Primary Air Filter, whichever occurs first.

(Activated Carbon Kit) [AL208648](#)

Never clean. Replace after every 750 hours or 1 year or with Engine Primary Air Filter, whichever occurs first.

TRANSMISSION

OIL FILTER

(IVT™) [AL206482](#)
 (Direct Drive™) [AL221066](#)
 (PowrQuad™) [AL221066](#)

Replace after first 100 hours then after first 750 hours and every 750 hours thereafter. Change Hydraulic Oil Filter as well.

(Click here for [capacity](#))

ENGINE

DIESEL PARTICULATE FILTER

[RE563694](#) (6175R, 6195R, 6215R S/N (-027000))
[DZ100484](#) (6175R, 6195R, 6215R S/N (027001-))
[RE565702](#) (6145R, 6155R, 6155RH S/N (-027000))
[RE566731](#) (6145R, 6155R, 6155RH S/N (027001-))

Replace within 250 hours after exhaust filter and warning light indicators are alerted on display.

ENGINE

DIESEL EXHAUST FILTER

[DZ114640](#)

Replace after every 4500 hours or 3 years, whichever occurs first.

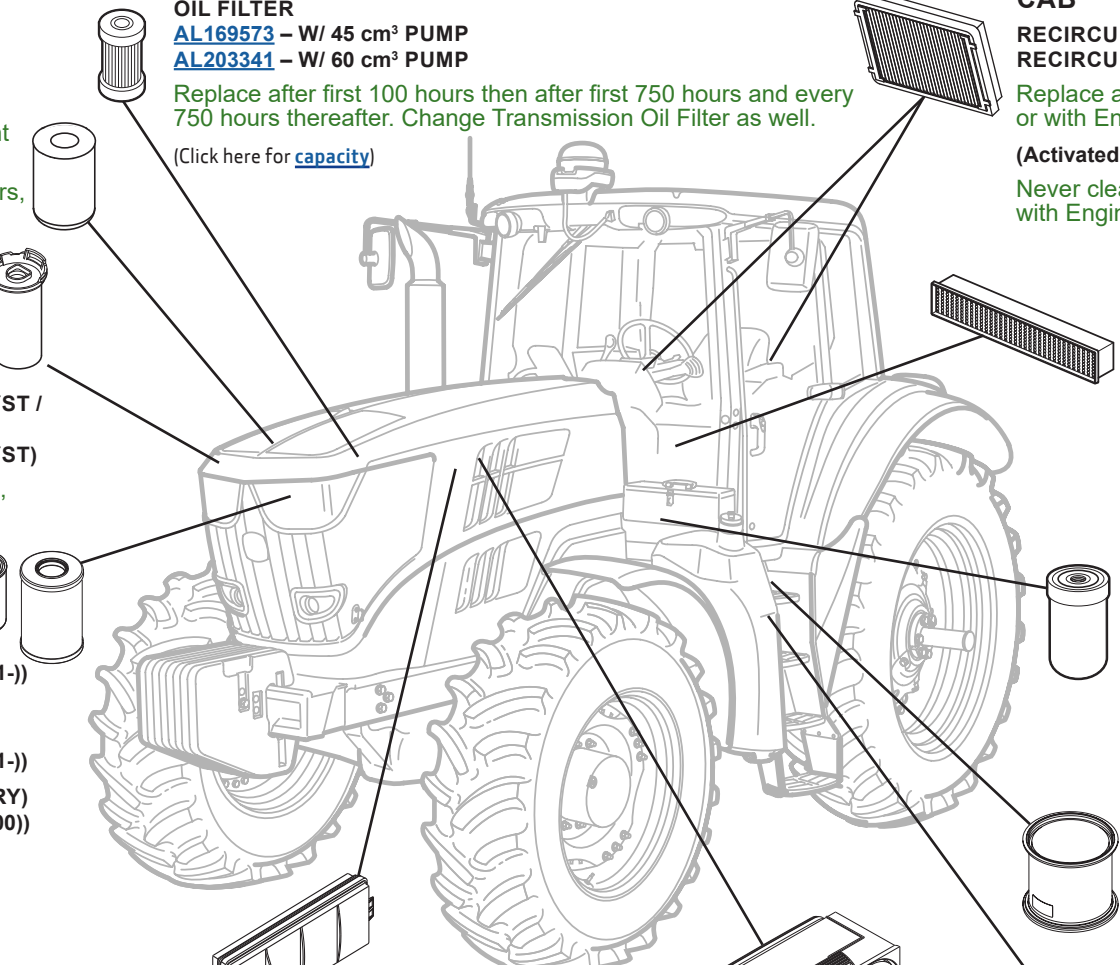

ENGINE

SECONDARY AIR FILTER

[AL215054](#)

Replace at every fourth change of Primary Air Filter, or after 4500 hours or 5 years, whichever occurs first.

ENGINE

PRIMARY AIR FILTER

[AL215053](#)

Replace after every 1500 hours or 2 years, or whenever the yellow caution light flashes and corresponding information appears in the CommandCenter™.



JOHN DEERE

Genuine Parts and Service

CAPACITIES

6R Final Tier 4 (FT4) Series Row-Crop Tractors – 6145R, 6155R, 6155RH, 6175R, 6195R and 6215R

CAPACITIES (Approximate):

Fuel Tank:

6145R, 6155R, 6155RH	270 L (71.3 gal)
6175R, 6195R, 6215R.....	330 L (87.2 gal)

DEF Tank:

John Deere Diesel Exhaust Fluid™

6145R, 6155R, 6155RH	16 L (4.2 gal)
6175R, 6195R, 6215R.....	20 L (5.3 gal)

Cooling System:

Cool-Gard™ II

Engine cooling and cab heating

6145R, 6155R, 6155RH	27 L (7.1 gal)
6175R, 6195R, 6215R.....	28 L (7.4 gal)

Crankcase:

Plus-50™ II

.....	23.5 L (6.2 gal)
-------	------------------

Transmission/Hydraulics:

Hy-Gard™

PowrQuad™ PLUS Transmission

6145R, 6155R, 6155RH	63 L (16.6 gal)
6175R, 6195R, 6215R.....	71 L (18.8 gal)

AutoQuad™ PLUS Transmission

6145R, 6155R	63 L (16.6 gal)
6175R, 6195R, 6215R.....	71 L (18.8 gal)

DirectDrive Transmission

6145R, 6155R	62 L (16.4 gal)
6175R, 6195R, 6215R.....	75 L (19.8 gal)

IVT™ Transmission

6145R, 6155R.....	75 L (19.8 gal)
6175R, 6195R, 6215R.....	81 L (21.4 gal)

Front-wheel Drive:

Hy-Gard™

2 Piece Front Axle

Axle housing (with TLS™).....	8.5 L (2.25 gal)
Axle housing (without TLS™).....	8.0 L (2.11 gal)
Final drives, per side (without brake).....	2.2 L (0.58 gal)
Final drives, per side (with brake).....	2.6 L (0.69 gal)

3 Piece Front Axle

6145R, 6155R, 6155RH

Axle housing (with TLS™).....	10.0 L (2.64 gal)
Axle housing (with TLS™, with brake).....	9.5 L (2.51 gal)
Axle housing (without TLS™).....	9.5 L (2.51 gal)
Final drives, per side (without brake).....	2.2 L (0.58 gal)
Final drives, per side (with brake).....	2.6 L (0.69 gal)

3 Piece Front Axle

6175R, 6195R, 6215R

Axle housing (with TLS™).....	11.8 L (3.12 gal)
Axle housing (without TLS™).....	10.3 L (2.72 gal)
Final drives, per side (without brake).....	1.8 L (0.48 gal)
Final drives, per side (with brake) (750 type Axle).....	2.2 L (0.58 gal)
Final drives, per side (with brake) (755 type Axle).....	2.3 L (0.61 gal)

Air-conditioning System:

R134a Refrigerant.....	1225 - 1275 g (2.70 - 2.81 lb)
Oil Volume (PAG oil).....	220 ml (7.44 fl oz)

